



LEXINGTON HOMES INC.



Rock Ridge Estates

8924 East Clearview Lane • Spokane, WA
Fall Festival of Homes Price: \$745,000

Tomlinson Valley, Inc.
MICHELE BUCK
509-570-4100
DON CAMPBELL
509-999-5545

www.rockridgetownhomes.com

The appliances for this home are supplied by



3 Bedrooms • 3.5 Bathrooms • 4171 Square Feet

UPPER
• FLOOR PLAN •

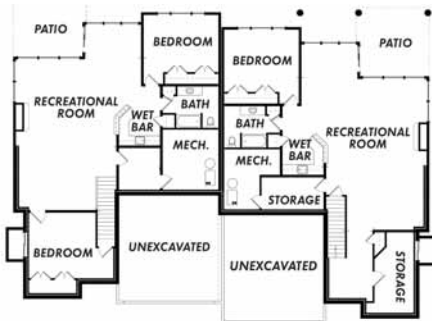

MAIN
• FLOOR PLAN •

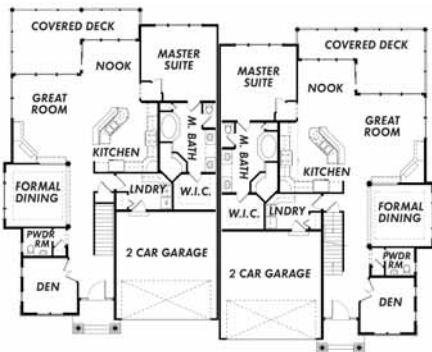

LOWER
• FLOOR PLAN •



FEATURES

- Superior Level of Craftsmanship
- Full Yard Maintenance and Gated Community
- Full Viking Kitchen Package
- Slab Granite and Custom Cabinets Throughout
- Security Systems and Built-In Entertainment Center with Flat Screen
- Main Floor Living, Master Suite, Mud Set Shower
- Easy Commute to All Parts of Spokane
- Home is Furnished

DIRECTIONS: I-90 to Argonne Road exit, north on Argonne Road, west on Columbia Drive, north on Vista Park Drive.

About the Builder

DAVE NERREN & BRIAN JONES
(P) 509-924-1519 • (F) 509-892-1208
info@lexingtonhomesinc.com
www.lexingtonhomesinc.com



Presented by Spokane Home Builders Association

www.spokanefestivalofhomes.com