



DINWIDDIE CONSTRUCTION INC.



McCarroll East 3rd Addition

9405 North Phoebe Drive • Spokane, WA
Fall Festival of Homes Price: \$375,000



Tomlinson Black
AIMEE STONER
509-979-6118

www.tb.com

The appliances for this home are supplied by



3 Bedrooms • 2.5 Bathrooms • 2050 Square Feet

FEATURES

- Located in a Walkable Community
- Covered Deck Featuring Beautiful Sunset Views
- Daylight Walk-Out Basement
- Home is Partially Furnished

DIRECTIONS: West on Francis Avenue to Indian Trail Road. North on Indian Trail Road, right on Barnes Road, left on North Phoebe Drive.

About the Builder

STEVE DINWIDDIE
(P) 509-532-1250 • (F) 509-536-0543
spokanebuilders@gmail.com
www.dinwiddiebuilt.com

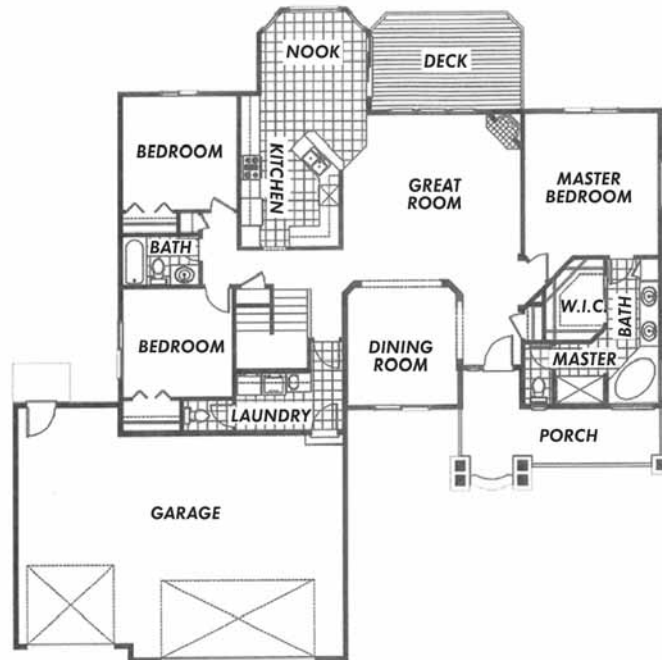

• MAIN FLOOR PLAN •



www.spokanefestivalofhomes.com