



# WATERFORD AT GRAPETREE



## Waterford at Grapetree

2106 East Touchmark Lane • Spokane, WA  
 Fall Festival of Homes Price: \$387,900



MARY JOHNSON  
 JASON NEIL  
 509-536-2929

[www.waterfordgrapetree.com](http://www.waterfordgrapetree.com)

2 Bedrooms • 2 Bathrooms • 1582 Square Feet

### FEATURES

- Gated Wooded Community
- Ages 55+
- Ask about the Fall Festival Discount
- Waterford on South Hill's Newest Neighborhood

**DIRECTIONS:** Grand Boulevard south to 29<sup>th</sup> Avenue, left at 29<sup>th</sup> Avenue, left on Lee Street to development entrance, first house on right.

#### About the Builder

TOUCHMARK DEVELOPMENT  
 & CONSTRUCTION  
 (P) 509-536-2929 • (F) 509-536-3999  
 jrn@touchmark.com  
 www.waterfordgrapetree.com



[www.spokanefestivalofhomes.com](http://www.spokanefestivalofhomes.com)

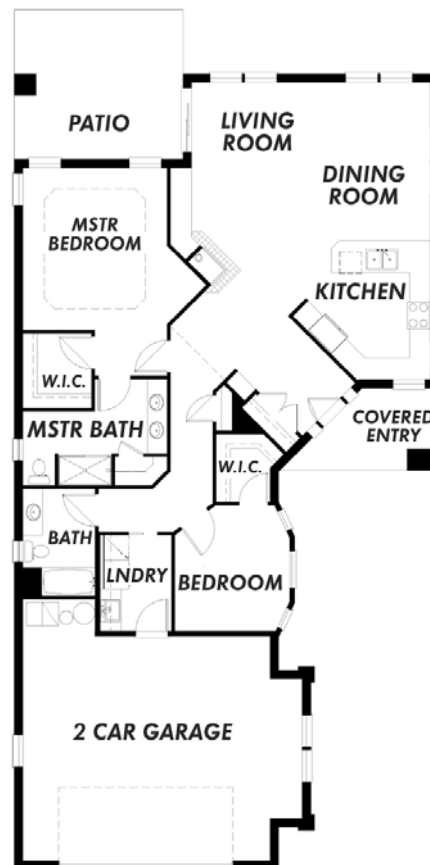

• MAIN FLOOR PLAN •