



# 22 VALLEY



11826 East Rivercrest Drive  
SPOKANE VALLEY

## RIVERCREST AT COYOTE ROCK

### FEATURES

\$285,616 | 2,167 SF | 4 BED | 3 BATH

- Waterfront views
- Active waterfront community
- Access to Centennial Trail and Spokane River
- Close proximity to downtown Spokane

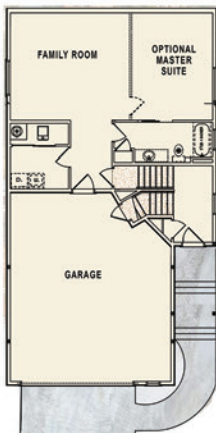

LOWER LEVEL



MAIN LEVEL

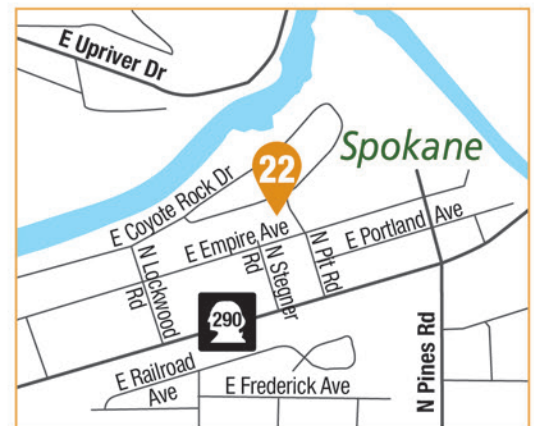

From Trent and Pines, go west on Trent one block to Pitt Rd. Turn right (north) on Pitt to East Rivercrest Dr. Turn left (west) on Rivercrest Dr. Home is the third on the left.



The Legacy Group  
Megan Reynolds  
509.939.1545  
meganreynolds@kw.com  
www.monogrambuilt.com

Staging By  
Home Staging Works

Monogram Homes  
Chris Close  
208.777.3000  
chris@buildmort.com  
www.monogrambuilt.com

SEPTEMBER 23-25 | SEPTEMBER 30-OCTOBER 2



www.SpokaneFestivalOfHomes.com

PRESENTED BY

